

Ref# 74001634

**NATIONAL REGISTER OF HISTORIC PLACES  
INVENTORY - NOMINATION FORM**

(Type all entries - complete applicable sections)

STATE: Ohio
COUNTY: Summit
FOR NPS USE ONLY
ENTRY DATE 5-3-74

**1. NAME**

COMMON:  
Twinsburg Congregational Church

AND/OR HISTORIC:

**2. LOCATION**

STREET AND NUMBER:  
Twinsburg Public Square

CITY OR TOWN:  
Twinsburg

CONGRESSIONAL DISTRICT:  
14 - John Seiberling

STATE: Ohio      CODE: 039      COUNTY: Summit      CODE: 153

**3. CLASSIFICATION**

CATEGORY (Check One)	OWNERSHIP	STATUS	ACCESSIBLE TO THE PUBLIC
<input type="checkbox"/> District <input checked="" type="checkbox"/> Building <input type="checkbox"/> Site <input type="checkbox"/> Structure <input type="checkbox"/> Object	<input type="checkbox"/> Public <input checked="" type="checkbox"/> Private <input type="checkbox"/> Both	Public Acquisition: <input type="checkbox"/> In Process <input type="checkbox"/> Being Considered	<input checked="" type="checkbox"/> Occupied <input type="checkbox"/> Unoccupied <input type="checkbox"/> Preservation work in progress
PRESENT USE (Check One or More as Appropriate)			
<input type="checkbox"/> Agricultural <input type="checkbox"/> Commercial <input type="checkbox"/> Educational <input type="checkbox"/> Entertainment	<input type="checkbox"/> Government <input type="checkbox"/> Industrial <input type="checkbox"/> Military <input type="checkbox"/> Museum	<input type="checkbox"/> Park <input type="checkbox"/> Private Residence <input checked="" type="checkbox"/> Religious <input type="checkbox"/> Scientific	<input type="checkbox"/> Transportation <input type="checkbox"/> Other (Specify) _____ _____ _____

**4. OWNER OF PROPERTY**

OWNER'S NAME:  
First Congregational Church-United Church of Christ

STREET AND NUMBER:  
9050 Church Street

CITY OR TOWN:  
Twinsburg

STATE: Ohio      CODE: 039

**5. LOCATION OF LEGAL DESCRIPTION**

COURTHOUSE, REGISTRY OF DEEDS, ETC.:  
Summit County Building

STREET AND NUMBER:  
72 South High Street

CITY OR TOWN:  
Akron

STATE: Ohio      CODE: 039

**6. REPRESENTATION IN EXISTING SURVEYS**

TITLE OF SURVEY:  
Historic American Buildings Survey

DATE OF SURVEY: 1934       Federal     State     County     Local

DEPOSITORY FOR SURVEY RECORDS:  
Library of Congress

STREET AND NUMBER:

CITY OR TOWN:  
Washington

STATE: D. C.      CODE: 011

SEE INSTRUCTIONS

STATE: Ohio
COUNTY: Summit
ENTRY NUMBER
DATE
FOR NPS USE ONLY

**7. DESCRIPTION**

CONDITION	(Check One)					
	<input checked="" type="checkbox"/> Excellent	<input type="checkbox"/> Good	<input type="checkbox"/> Fair	<input type="checkbox"/> Deteriorated	<input type="checkbox"/> Ruins	<input type="checkbox"/> Unexposed
	(Check One)			(Check One)		
	<input checked="" type="checkbox"/> Altered	<input type="checkbox"/> Unaltered	<input type="checkbox"/> Moved	<input checked="" type="checkbox"/> Original Site		

DESCRIBE THE PRESENT AND ORIGINAL (if known) PHYSICAL APPEARANCE

This is a frame church building in the Greek Revival Style, with a steeple of three octagonal stages between its base and the spire. The temple-like facade is divided into three bays by two attached Doric columns and two sets of flat pilasters. these elements support a well-proportioned entablature and pediment. The central facade bay has large double doors with a recessed panel above, and the side bays have shuttered windows. The side elevations have four windows with small-pane sash. The steeple was rebuilt in 1856, and the clock was installed in the steeple in 1896.

The interior is less ornamented than the exterior. Where it was originally completely plain, the chancel area was remodeled in 1908, when the chandeliers were added, and again in 1963, when the present arrangement was made, with a divided chancel and a background set piece consisting of four square pilasters and an entablature. The pews are of the typical New England type, with two aisles and divided in the center. The original plaster rosette in the center of the ceiling gives the only touch of original elegance.

A concrete block addition was constructed to the rear of the church as an educational annex in 1954, and considerable general repair has been done over the years, especially in 1949, 1952 and 1963, but the basic design and structure of the church building are unchanged.

SEE INSTRUCTIONS

**6. SIGNIFICANCE**

PERIOD (Check One or More as Appropriate)

- |  |                                       |  |                                       |
|--|---------------------------------------|--|---------------------------------------|
| <input type="checkbox"/> Pre-Columbian | <input type="checkbox"/> 16th Century | <input type="checkbox"/> 18th Century            | <input type="checkbox"/> 20th Century |
| <input type="checkbox"/> 15th Century  | <input type="checkbox"/> 17th Century | <input checked="" type="checkbox"/> 19th Century |                                       |

SPECIFIC DATE(S) (If Applicable and Known) 1848; 1856

AREAS OF SIGNIFICANCE (Check One or More as Appropriate)

- |  |   |  |  |
|--|---|--|--|
| <input type="checkbox"/> Aboriginal              | <input type="checkbox"/> Education              | <input type="checkbox"/> Political           | <input type="checkbox"/> Urban Planning  |
| <input type="checkbox"/> Prehistoric             | <input type="checkbox"/> Engineering            | <input type="checkbox"/> Religion/Philosophy | <input type="checkbox"/> Other (Specify) |
| <input type="checkbox"/> Historic                | <input type="checkbox"/> Industry               | <input type="checkbox"/> Science             | _____                                    |
| <input type="checkbox"/> Agriculture             | <input type="checkbox"/> Invention              | <input type="checkbox"/> Sculpture           | _____                                    |
| <input checked="" type="checkbox"/> Architecture | <input type="checkbox"/> Landscape Architecture | <input type="checkbox"/> Social/Humanitarian | _____                                    |
| <input type="checkbox"/> Art                     | <input type="checkbox"/> Literature             | <input type="checkbox"/> Theater             | _____                                    |
| <input type="checkbox"/> Commerce                | <input type="checkbox"/> Military               | <input type="checkbox"/> Transportation      | _____                                    |
| <input type="checkbox"/> Communications          | <input type="checkbox"/> Music                  |  | _____                                    |
| <input type="checkbox"/> Conservation            |   |  | _____                                    |

STATEMENT OF SIGNIFICANCE

In addition to being a superior example of the late colonial New England meetinghouse adapted to the Greek Revival idiom, this building is very significant as the only one remaining on its site of a group of four related buildings. The similar church at Streetsboro has been removed to the Western Reserve Village near Peninsula; a Methodist church identical to the Streetsboro church, which also stood on the Twinsburg Square, has been destroyed; and the Brecksville church, whose facade was identical but whose steeple was different, burned in 1965.

The Twinsburg Congregational Church was organized in 1822. It used a log schoolhouse, and later a frame building on the Public Square. A church and school building was erected in 1832 on the east side of the Square, and existed until 1948. The present church building was erected in 1848 at a cost of \$3,300. The steeple was destroyed in a windstorm of 1856 and replaced at a cost of \$210.

The architect-builder is unknown. On the basis of the similarity of the facade to that at Brecksville (Doric columns instead of pilasters), and the proximity to Hudson, it has been suggested that the architect-builder was Simeon Porter, the Hudson master builder. On the other hand, the steeple design is so similar to those of the Streetsboro church, designed by James Clark, and the Twinsburg Methodist Church, built by William Clark, that one of the Clarks seems equally likely as the builder.

SEE INSTRUCTIONS

**9. MAJOR BIBLIOGRAPHICAL REFERENCES**

History of Twinsburg (Twinsburg Historical Society, 1967), 47-48.  
 Sarah M. Riley, First Congregational Church-United Church of Christ  
 Twinsburg, 1967, 12-13.  
 Eric Johannesen, "Simeon Porter: Ohio Architect," Ohio History,  
 Summer 1965, 176.

**10. GEOGRAPHICAL DATA**

LATITUDE AND LONGITUDE COORDINATES DEFINING A RECTANGLE LOCATING THE PROPERTY			O R	LATITUDE AND LONGITUDE COORDINATES DEFINING THE CENTER POINT OF A PROPERTY OF LESS THAN TEN ACRES		
CORNER	LATITUDE	LONGITUDE		LATITUDE	LONGITUDE	
	Degrees Minutes Seconds	Degrees Minutes Seconds		Degrees Minutes Seconds	Degrees Minutes Seconds	
NW	° ' "	° ' "		41° 18' 43"	81° 26' 32"	
NE	° ' "	° ' "				
SE	° ' "	° ' "				
SW	° ' "	° ' "				

APPROXIMATE ACREAGE OF NOMINATED PROPERTY: **less than one**

LIST ALL STATES AND COUNTIES FOR PROPERTIES OVERLAPPING STATE OR COUNTY BOUNDARIES

STATE:	CODE	COUNTY	CODE

**11. FORM PREPARED BY**

NAME AND TITLE: **Eric Johannesen, Preservationist**

ORGANIZATION: **Western Reserve Historical Society**      DATE: **Sept. 1973**

STREET AND NUMBER: **10825 East Boulevard**

CITY OR TOWN: **Cleveland**      STATE: **Ohio**      CODE: **039**

**12. STATE LIAISON OFFICER CERTIFICATION**

As the designated State Liaison Officer for the National Historic Preservation Act of 1966 (Public Law 89-665), I hereby nominate this property for inclusion in the National Register and certify that it has been evaluated according to the criteria and procedures set forth by the National Park Service. The recommended level of significance of this nomination is:

National  State  Local

Name \_\_\_\_\_

Title \_\_\_\_\_

Date \_\_\_\_\_

**NATIONAL REGISTER VERIFICATION**

I hereby certify that this property is included in the National Register.

\_\_\_\_\_  
 Director, Office of Archeology and Historic Preservation

Date \_\_\_\_\_

ATTEST:

\_\_\_\_\_  
 Keeper of The National Register

Date \_\_\_\_\_

SEE INSTRUCTIONS

Twinsburg  
Congregational Church

41° 18' 43"

81° 26' 32"

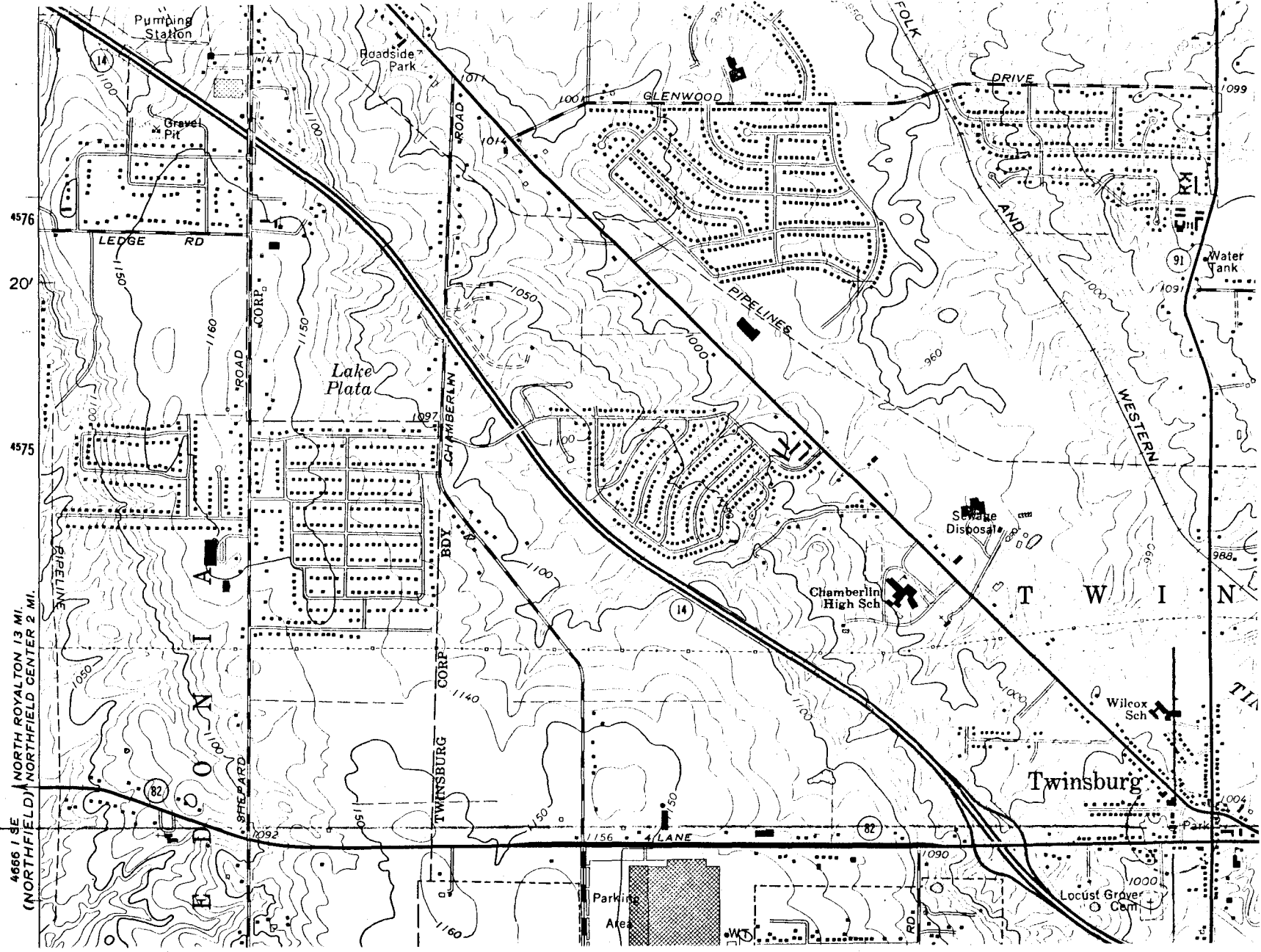

4666 / SE NORTH ROYALTON 13 MI.  
(NORTHFIELD) NORTHFIELD CENTER 2 MI.

Form 10-301  
(July 1968)

UNITED STATES DEPARTMENT OF THE INTERIOR  
NATIONAL PARK SERVICE  
**NATIONAL REGISTER OF HISTORIC PLACES**  
**PROPERTY MAP FORM**  
(Type all entries - attach to or enclose with map)

**1. NAME**

<b>COMMON</b> Twinsburg Congregational Church	<b>AND/OR HISTORIC</b>	<b>NUMERIC CODE (Assigned by NPS)</b>
--	------------------------	---------------------------------------

**2. LOCATION**

<b>STATE</b> Ohio	<b>COUNTY</b> Summit	<b>TOWN</b> Twinsburg
-------------------	----------------------	-----------------------

**STREET AND NUMBER**

Twinsburg Public Square

**3. MAP REFERENCE**

<b>SOURCE</b> U.S.G.S. Twinsburg	<b>DATE</b> 1970	<b>SCALE</b> 1:24,000
-------------------------------------	---------------------	--------------------------

**REQUIREMENTS: PROPERTY BOUNDARIES, WHERE REQUIRED, AND NORTH ARROW.**

NATIONAL REGISTER OF HISTORIC PLACES

PROPERTY PHOTOGRAPH FORM

(Type all entries - attach to or enclose with photograph)

STATE	
Ohio	
COUNTY	
Summit	
FOR NPS USE ONLY	
ENTRY NUMBER	DATE

SEE INSTRUCTIONS

<b>1. NAME</b>			
COMMON:		Twinsburg Congregational Church	
AND/OR HISTORIC:			
<b>2. LOCATION</b>			
STREET AND NUMBER:			
Twinsburg Public Square			
CITY OR TOWN:			
Twinsburg			
STATE:	CODE	COUNTY:	CODE
Ohio	039	Summit	153
<b>3. PHOTO REFERENCE</b>			
PHOTO CREDIT:		E. Johannesen	
DATE OF PHOTO:		Sept. 1973	
NEGATIVE FILED AT:			
Western Reserve Historical Society			
<b>4. IDENTIFICATION</b>			
DESCRIBE VIEW, DIRECTION, ETC.			
Northwest corner of church, showing educational annex to right, looking southeast.			

INT: 154-72

NATIONAL REGISTER OF HISTORIC PLACES

PROPERTY PHOTOGRAPH FORM

(Type all entries - attach to or enclose with photograph)

STATE	
Ohio	
COUNTY	
Summit	
FOR NPS USE ONLY	
ENTRY NUMBER	DATE

SEE INSTRUCTIONS

<b>1. NAME</b>			
COMMON:		Twinsburg Congregational Church	
AND/OR HISTORIC:			
<b>2. LOCATION</b>			
STREET AND NUMBER:			
Twinsburg Public Square			
CITY OR TOWN:			
Twinsburg			
STATE:	CODE	COUNTY:	CODE
Ohio	039	Summit	153
<b>3. PHOTO REFERENCE</b>			
PHOTO CREDIT:		E. Johannesen	
DATE OF PHOTO:		Sept. 1973	
NEGATIVE FILED AT:			
Western Reserve Historical Society			
<b>4. IDENTIFICATION</b>			
DESCRIBE VIEW, DIRECTION, ETC.			
East facade, looking northwest.			

INT: 154-72

XXXXXX  
8727

May 13, 1974

First Congregational Church-United Church of Christ  
9050 Church Street  
Twinsburg, Ohio 44087

Dear Sirs:

I am pleased to inform you that the Twinsburg Congregational Church, Twinsburg Public Square, Twinsburg, has been entered in the National Register of Historic Places by the National Park Service, United States Department of Interior.

The nomination was made in connection with a state plan to identify and document prehistoric and historic places in Ohio which qualify for National Register status under provisions of the National Historic Preservation Act of 1966. All nominations are approved by the Ohio Historic Site Preservation Advisory Board.

Enclosed is a brochure explaining the purposes and goals of the National Register of Historic Places.

Congratulations for recognizing the importance of, and the need for, the careful and sensible preservation of Ohio's landmarks. Your farsightedness will surely serve as an example to other individuals and organizations in this state.

Sincerely,

Judith Kitchen  
Architectural Historian  
Deputy Historic Preservation Officer

JK:dal  
enclosure



# Ohio Historic Preservation Office

## National Register of Historic Places File Checklist

The following materials are contained in this file of the National Register form for:

Name: Twinsburg Congregational Church

County: Summit

Original National Register of Historic Places nomination form

Multiple Property Nomination form

Photograph(s)

Photograph(s) (copies)

USGS map(s)

USGS map(s) (copies)

Sketch map(s)/figure(s)/exhibit(s)

Correspondence

Other news clipping

\_\_\_\_\_  
\_\_\_\_\_