

# OHIO HISTORIC INVENTORY

No. <b>SUM - 116</b>	4. Present Name(s) <b>Stein Barn</b>	<b>ENTERED</b> <b>6/11/79</b>	REFNUM <b>79002801</b>	1. No. <b>SUM-116</b>
County <b>Summit</b>	5. Other Name(s) <b>Bath Township School</b>			
Location of Negatives <b>PHS</b>				

Specific Location <b>4655 Akron-Medina Road</b>	16. Thematic Category <b>C, G, N</b>	28. No. of Stories <b>1</b>	2. County <b>Summit</b>
City or Town If Rural, Township & Vicinity <b>Bath Twp., Ghent</b>	17. Date(s) or Period <b>ca. 1870</b>	29. Basement? Yes <input type="checkbox"/> No <input checked="" type="checkbox"/>	
Site Plan with North Arrow 	18. Style or Design <b>Victorian vernacular</b>	30. Foundation Material <b>1 course ashlar</b>	3. Present Name(s) <b>Stein Barn</b>
Coordinates Lat. <b>West Richfield</b> Long. _____	19. Architect or Engineer	31. Wall Construction <b>post &amp; beam</b>	
U.T.M. Reference <b>7 44 3 8 3 0 4 5 5 3 9 7 0</b>	20. Contractor or Builder	32. Roof Type & Material <b>gable/shingle</b>	4. Other Name(s) <b>Bath Township Schoolhouse</b>
Site Building <input type="checkbox"/> Structure <input type="checkbox"/> Object <input type="checkbox"/>	21. Original Use, if apparent <b>School</b>	33. No. of Bays Front <b>2</b> Side <b>3</b>	
On National Register? Yes <input type="checkbox"/> No <input checked="" type="checkbox"/>	22. Present Use <b>Garage, Storage</b>	34. Wall Treatment <b>clanboard</b>	5. Other Name(s) <b>Bath Township Schoolhouse</b>
Part of Estab. Hist. Dist.? Yes <input type="checkbox"/> No <input checked="" type="checkbox"/>	23. Ownership Public <input type="checkbox"/> Private <input checked="" type="checkbox"/>	35. Plan Shape <b>rectangular</b>	
Name of Established District	24. Owner's Name & Address, if known <b>Edward S. Stein</b> <b>4655 Akron-Medina Rd, Copley</b>	36. Changes (Explain in #42) Addition <input type="checkbox"/> Altered <input type="checkbox"/> Moved <input checked="" type="checkbox"/>	
	25. Open to Public? Yes <input type="checkbox"/> No <input checked="" type="checkbox"/>	37. Condition Interior <b>fair</b> Exterior <b>good</b>	
	26. Local Contact Person or Organization	38. Preservation Underway? Yes <input checked="" type="checkbox"/> No <input type="checkbox"/>	
	27. Other Surveys in Which Included	39. Endangered? By What? Yes <input type="checkbox"/> No <input checked="" type="checkbox"/>	
		40. Visible from Public Road? Yes <input checked="" type="checkbox"/> No <input type="checkbox"/>	
		41. Distance from and Frontage on Road <b>100'</b>	

Further Description of Important Features  
Small rectangular structure with evenly spaced vertical windows enclosed with shutters. Narrow cornice, corner boards, and siding. Plain surrounds with projecting architraves. Side entrance wing with garage door alteration. Wainscot, blackboard, and other schoolroom fixtures visible within.

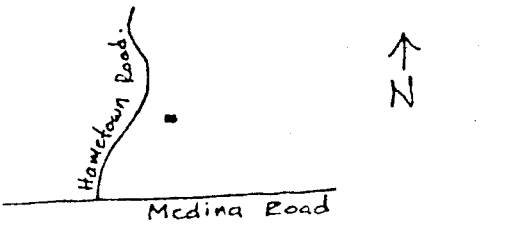
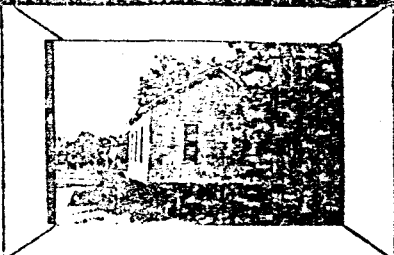

History and Significance  
The schoolhouse does not appear in its present location until 1910. It may be the school on Medina Road west of Hametown Road in 1874 and 1891. The school is one of the few early educational buildings standing in Bath Township.

Description of Environment and Outbuildings  
The structure stands in front of the Stein House, with large trees and a drive to one side and an open field to the other. There is a lake behind the building.

Sources of Information <b>Summit County Atlases - 1856, 1874, 1891, 1910.</b>	46. Prepared by <b>Ford/Fisher</b>
	47. Organization <b>PHS</b>
	48. Date <b>9/77</b>
	49. Revision Date(s)

# Ohio Historic Preservation Office

Ohio Historical Center I-71 & 17th Avenue Columbus, Ohio 43211 (614) 466-1500

June 22, 1979

Mr. Edward S. Stein  
4655 Akron-Medina Rd.  
Copley, Ohio 44321

Dear Mr. Stein:

I am pleased to inform you that the Bath Township Multiple Resource Area, Bath Township, has been entered in the National Register of Historic Places by the Heritage Conservation and Recreation Service, United States Department of the Interior.

The nomination was made in connection with a state plan to identify and document prehistoric and historic places in Ohio which qualify for National Register status under provisions of the National Historic Preservation Act of 1966. All nominations are approved by the Ohio Historic Site Preservation Advisory Board.

Enclosed is information explaining the purposes and goals of the National Register of Historic Places.

Sincerely,

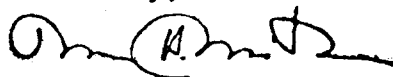

Thomas H. Smith  
State Historic Preservation Officer  
Director, Ohio Historical Society

THS:cw

X. c: Bath Twp. Trustees  
Summit County Commissioners  
NEFCO  
Eric Johannesen, Regional Preservationist

# Ohio Historic Preservation Office

## National Register of Historic Places File Checklist

The following materials are contained in this file of the National Register form for:

Name: Bath Township School

County: Summit

MPD Cover Form: Bath Township MRA

County Filed In: Summit

Original National Register of Historic Places nomination form

Ohio Historic Inventory form

Photograph(s)

Photograph(s) (copies)

USGS map(s)

USGS map(s) (copies)

Sketch map(s)/figure(s)/exhibit(s)

Correspondence

Other \_\_\_\_\_

\_\_\_\_\_

\_\_\_\_\_