

UNITED STATES DEPARTMENT OF THE INTERIOR
NATIONAL PARK SERVICE

FOR NPS USE ONLY	
RECEIVED	
DATE ENTERED	12-14-78

**NATIONAL REGISTER OF HISTORIC PLACES
INVENTORY -- NOMINATION FORM**

SEE INSTRUCTIONS IN *HOW TO COMPLETE NATIONAL REGISTER FORMS*
TYPE ALL ENTRIES -- COMPLETE APPLICABLE SECTIONS

1 NAME

HISTORIC Kirby, James, Mill

AND/OR COMMON

2 LOCATION

STREET & NUMBER Camp Julia Crowell
Route 303

CITY, TOWN Richfield

STATE Ohio

VICINITY OF
CODE
035

NOT FOR PUBLICATION
CONGRESSIONAL DISTRICT
22 - Charles A. Vanik
COUNTY CODE
Summit 153

3 CLASSIFICATION

CATEGORY	OWNERSHIP	STATUS	PRESENT USE
<input type="checkbox"/> DISTRICT	<input type="checkbox"/> PUBLIC	<input checked="" type="checkbox"/> OCCUPIED	<input type="checkbox"/> AGRICULTURE <input type="checkbox"/> MUSEUM
<input checked="" type="checkbox"/> BUILDING(S)	<input checked="" type="checkbox"/> PRIVATE	<input type="checkbox"/> UNOCCUPIED	<input type="checkbox"/> COMMERCIAL <input type="checkbox"/> PARK
<input type="checkbox"/> STRUCTURE	<input type="checkbox"/> BOTH	<input type="checkbox"/> WORK IN PROGRESS	<input checked="" type="checkbox"/> EDUCATIONAL <input type="checkbox"/> PRIVATE RESIDENCE
<input type="checkbox"/> SITE	PUBLIC ACQUISITION	ACCESSIBLE	<input checked="" type="checkbox"/> ENTERTAINMENT <input type="checkbox"/> RELIGIOUS
<input type="checkbox"/> OBJECT	<input type="checkbox"/> IN PROCESS	<input checked="" type="checkbox"/> YES: RESTRICTED	<input type="checkbox"/> GOVERNMENT <input type="checkbox"/> SCIENTIFIC
	<input type="checkbox"/> BEING CONSIDERED	<input type="checkbox"/> YES: UNRESTRICTED	<input type="checkbox"/> INDUSTRIAL <input type="checkbox"/> TRANSPORTATION
		<input type="checkbox"/> NO	<input type="checkbox"/> MILITARY <input type="checkbox"/> OTHER:

4 OWNER OF PROPERTY

NAME Lake Erie Girl Scout Council

STREET & NUMBER 1001 Huron Road

CITY, TOWN Cleveland

VICINITY OF

STATE Ohio 44115

5 LOCATION OF LEGAL DESCRIPTION

COURTHOUSE, REGISTRY OF DEEDS, ETC. Summit County Courthouse

STREET & NUMBER 72 S. High Street

CITY, TOWN Akron

STATE Ohio 44308

6 REPRESENTATION IN EXISTING SURVEYS

TITLE

DATE

FEDERAL STATE COUNTY LOCAL

DEPOSITORY FOR SURVEY RECORDS

CITY, TOWN

STATE

7 DESCRIPTION

CONDITION		CHECK ONE	CHECK ONE
<input type="checkbox"/> EXCELLENT	<input type="checkbox"/> DETERIORATED	<input checked="" type="checkbox"/> UNALTERED	<input checked="" type="checkbox"/> ORIGINAL SITE
<input checked="" type="checkbox"/> GOOD	<input type="checkbox"/> RUINS	<input type="checkbox"/> ALTERED	<input type="checkbox"/> MOVED DATE _____
<input type="checkbox"/> FAIR	<input type="checkbox"/> UNEXPOSED		

DESCRIBE THE PRESENT AND ORIGINAL (IF KNOWN) PHYSICAL APPEARANCE

The mill is wood frame, measuring 22 by 24 feet. It has a gable roof with wide eaves, exposed rafters, and cross-bracing in the end gables. The gables also have board and batten siding, which becomes horizontal lap siding below the eave line. The wheel, with spokes and rims of cypress and water buckets of oak, rests on ball bearings. This allows the water wheel's operation under the slightest pressure. An exterior staircase leads to a lower shed-roof porch. The random ashlar of the exposed foundation and dam is also used in a nearby sundial.

The interior of the mill is intact. It has vertical boarded wainscoting and stained wooden trim.

8 SIGNIFICANCE

PERIOD	AREAS OF SIGNIFICANCE -- CHECK AND JUSTIFY BELOW			
<input type="checkbox"/> PREHISTORIC	<input type="checkbox"/> ARCHEOLOGY-PREHISTORIC	<input type="checkbox"/> COMMUNITY PLANNING	<input type="checkbox"/> LANDSCAPE ARCHITECTURE	<input type="checkbox"/> RELIGION
<input type="checkbox"/> 1400-1499	<input type="checkbox"/> ARCHEOLOGY-HISTORIC	<input type="checkbox"/> CONSERVATION	<input type="checkbox"/> LAW	<input type="checkbox"/> SCIENCE
<input type="checkbox"/> 1500-1599	<input type="checkbox"/> AGRICULTURE	<input type="checkbox"/> ECONOMICS	<input type="checkbox"/> LITERATURE	<input type="checkbox"/> SCULPTURE
<input type="checkbox"/> 1600-1699	<input type="checkbox"/> ARCHITECTURE	<input type="checkbox"/> EDUCATION	<input type="checkbox"/> MILITARY	<input type="checkbox"/> SOCIAL/HUMANITARIAN
<input type="checkbox"/> 1700-1799	<input type="checkbox"/> ART	<input checked="" type="checkbox"/> ENGINEERING	<input type="checkbox"/> MUSIC	<input type="checkbox"/> THEATER
<input type="checkbox"/> 1800-1899	<input type="checkbox"/> COMMERCE	<input type="checkbox"/> EXPLORATION/SETTLEMENT	<input type="checkbox"/> PHILOSOPHY	<input type="checkbox"/> TRANSPORTATION
<input checked="" type="checkbox"/> 1900-	<input type="checkbox"/> COMMUNICATIONS	<input type="checkbox"/> INDUSTRY	<input type="checkbox"/> POLITICS/GOVERNMENT	<input type="checkbox"/> OTHER (SPECIFY)
		<input checked="" type="checkbox"/> INVENTION		

SPECIFIC DATES 1919 BUILDER/ARCHITECT James Kirby , Mr. Pardee

STATEMENT OF SIGNIFICANCE

The James Kirby Mill is the hand-built design of the famous American engineer and inventor, James Kirby (1885-1971). It contained the workshop where many of his inventions were conceived, and the first water wheel mounted on ball bearings.

Kirby purchased the farm in 1919 from descendants of Heman Oviatt, an early settler in Richfield Township. From timber cut on the site, Kirby built the mill for his workshop and supervised a local millwright, Mr. Pardee, in the construction of the overshot water wheel for the generation of electricity for the farm.

Kirby was best known for his invention of the vacuum cleaner, the wringerless washing machine, a dishwashing machine, an electric radiator, shock absorbers, ironing machines, window washers, radio conductors, and a dry cleaning machine. Kirby held more than two hundred patents, and many of his inventions were developed in the mill. In 1936, Lowell Thomas wrote a booklet on Kirby's career, in which he called Kirby "the man who revolutionized the American home." Thomas described the mill as follows:

"When the house was first built there was no electric service. Kirby constructed a rustic mill house with a water wheel to generate the juice. It was the first of its kind. Mounted on ball bearings, it is so sensitive that a mere trickle of water is enough to generate all the current he needed for his house and all the outbuildings. Since the wheel was installed the community has been electrified. The mill house serves today as Mr. Kirby's workshop."

The Kirby property was purchased by the Lake Erie Girl Scout Council in 1973 and is used for educational and social functions.

9 MAJOR BIBLIOGRAPHICAL REFERENCES

1. Beautiful Ohio, Ohio Department of Economic and Commercial Development, Pam.
2. Thomas, The Man Who Revolutionized the American Home, The Scott and Fetzer Company, Cleveland, 1936.
3. An Outline History of Richfield Township, Richfield Historical Society, 1968.

10 GEOGRAPHICAL DATA

ACREAGE OF NOMINATED PROPERTY Less than 1 acre

QUADRANGLE NAME West Richfield

QUADRANGLE SCALE 1:24,000

UTM REFERENCES

A 117 443110 45644810

B

C

D

E

F

G

H

VERBAL BOUNDARY DESCRIPTION The nominated property is located on the stream at the south end of the lower lake at Camp Julia Crowell, 400 feet north of State Route 303, and is 100 feet by 100 feet.

LIST ALL STATES AND COUNTIES FOR PROPERTIES OVERLAPPING STATE OR COUNTY BOUNDARIES

STATE	CODE	COUNTY	CODE
STATE	CODE	COUNTY	CODE

11 FORM PREPARED BY

NAME / TITLE

Eric Johannesen, Preservationist

ORGANIZATION

Western Reserve Historical Society

DATE

March 1978

STREET & NUMBER

10825 East Boulevard

TELEPHONE

216-721-5722

CITY OR TOWN

Cleveland

STATE

Ohio 44106

12 STATE HISTORIC PRESERVATION OFFICER CERTIFICATION

THE EVALUATED SIGNIFICANCE OF THIS PROPERTY WITHIN THE STATE IS:

NATIONAL

STATE

LOCAL

As the designated State Historic Preservation Officer for the National Historic Preservation Act of 1966 (Public Law 89-665), I hereby nominate this property for inclusion in the National Register and certify that it has been evaluated according to the criteria and procedures set forth by the National Park Service.

STATE HISTORIC PRESERVATION OFFICER SIGNATURE



TITLE State Historic Preservation Officer

DATE 4/3/78

FOR NPS USE ONLY

I HEREBY CERTIFY THAT THIS PROPERTY IS INCLUDED IN THE NATIONAL REGISTER

DATE

KEEPER OF THE NATIONAL REGISTER

ATTEST:

DATE

CHIEF OF REGISTRATION

The Mill - Camp Julia Crowell
Richfield, Summit, Ohio
17-443110-4566480



WEST RICHFIELD QUADRANGLE
OHIO
7.5 MINUTE SERIES (TOPOGRAPHIC)

4866 / SE
(NORTHFIELD)

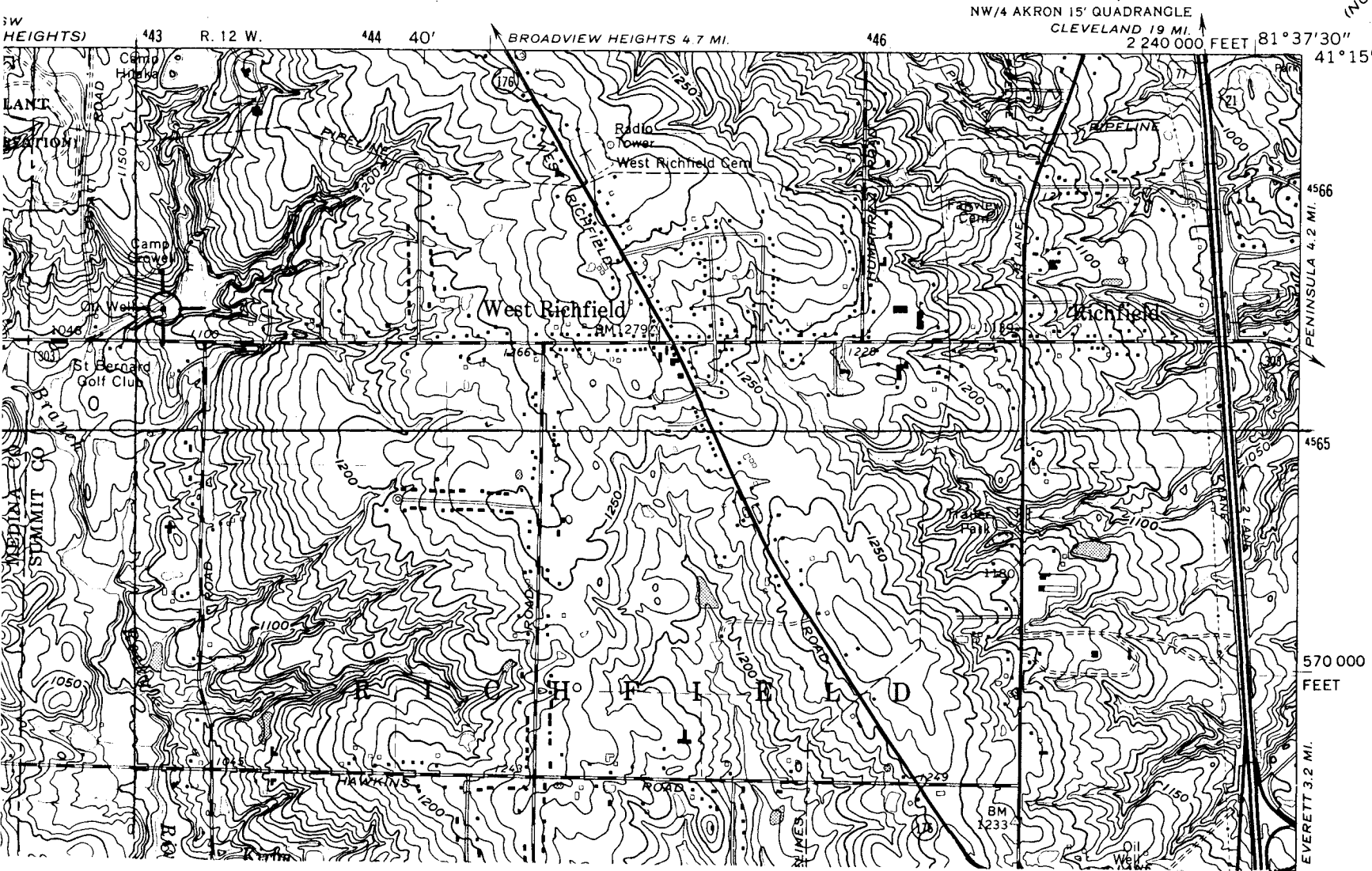

January 17, 1979

Ms. Clare Dowdall
Program Services Director
Lake Erie Girl Scout Council
1001 Huron Road
Cleveland, Ohio 44115

Dear Ms. Dowdall:

I am pleased to inform you that the James Kirby Mill, Camp Julia Crowell, Richfield, has been entered in the National Register of Historic Places by the Heritage Conservation and Recreation Service, United States Department of the Interior.

The nomination was made in connection with a state plan to identify and document prehistoric and historic places in Ohio which qualify for National Register status under provisions of the National Historic Preservation Act of 1966. All nominations are approved by the Ohio Historic Site Preservation Advisory Board.

Enclosed is information explaining the purposes and goals of the National Register of Historic Places.

Sincerely,

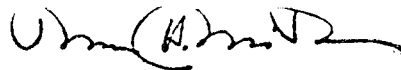

Thomas H. Smith
State Historic Preservation Officer
Director, Ohio Historical Society

THS:cw

X. c: Eric Johannesen, Regional Preservationist
NEFCO
Mayor of Richfield

Ohio Historic Preservation Office
Ohio Historical Center I-71 & 17th Avenue Columbus, Ohio 43211 (614) 466-1500

Ohio Historic Preservation Office

National Register of Historic Places File Checklist

The following materials are contained in this file of the National Register form for:

Name: Kirby, James, Mill

County: Summit

Original National Register of Historic Places nomination form

Multiple Property Nomination form

Photograph(s)

Photograph(s) (copies)

USGS map(s)

USGS map(s) (copies)

Sketch map(s)/figure(s)/exhibit(s)

Correspondence

Other _____

